

QCT26K1

DC~26.5GHz, 100W

Features:
 * Low VSWR
 * Broadband

Applications:
 * Transmitters
 * Antennas
 * Laboratory Test
 * Impedance Matching

Electrical

Frequency Range:	DC~26.5GHz
Average Power ¹ :	100W@25°C max.
Impedance:	50Ω
VSWR:	1.40 max.
Peak Power:	500W (5μS pulse width, 10% duty cycle)

[1] Derated linearly to 5W@125°C.

Mechanical

Size ² :	Φ63*108.4mm Φ2.48*4.268in
Weight:	400g
Connectors:	SMA
Housing:	Aluminum
Outer Conductor:	Gold plated brass
Male Inner Conductor:	Gold plated brass
Female Inner Conductor:	Gold plated beryllium copper

[2] Exclude connectors.

Environmental

Temperature:	-55~+85°C
--------------	-----------

Outline Drawings

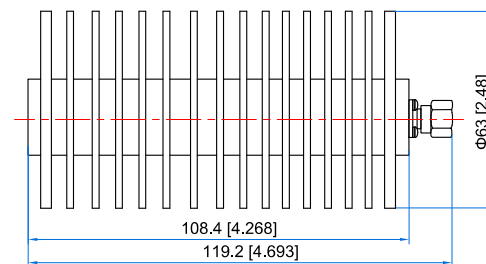

Unit: mm [in]
 Tolerance: ±0.5mm [±0.02in]

How To Order

QCT26K1-X-Y

X: Frequency in GHz

Y: Connector type

Connector naming rules:

S - SMA male

SF - SMA female

Examples:

To order a termination, DC-26.5GHz, SMA male, specify QCT26K1-26.5-S.

Customization is available upon request.